



Instruction Manual

9" PORTABLE DVD PLAYER WITH DIGITAL TV TUNER

ITEM CODE.: DV078191 / DV078195



MPEG4



BEFORE USING THIS PRODUCT, READ, UNDERSTAND,
AND FOLLOW THESE INSTRUCTIONS.

Save this booklet for future reference.

SAFETY INFORMATION

CAUTION:

DVD/VIDEO CD/CD PLAYER IS A CLASS 1 LASER PRODUCT. HOWEVER THIS DVD/VIDEO, CD/CD PLAYER USES A VISIBLE LASER BEAM WHICH COULD CAUSE HAZARDOUS RADIATION EXPO SURE IF DIRECTED. BE SURE TO OPERATE THE DVD/VIDEO CD/CD PLAYER CORRECTLY AS INSTRUCTED.

WHEN THIS DVD/VIDEO CD/CD PLAYER IS PLUGGED TO THE WALL OUTLET, DO NOT PLACE YOUR EYES CLOSE TO THE OPENING OF THE DISC TRAY AND OTHER OPENINGS TO LOOK INTO THE INSIDE OF THIS PLAYER.

USE OF CONTROLS OR ADJUSTMENTS OR PERFORMANCE OF PROCEDURES OTHER THAN THOSE SPECIFIED HEREIN MAY RESULT IN HAZARDOUS RADIATION EXPOSURE.

DO NOT OPEN COVERS AND REPAIR YOURSELF. REFER SERVICING TO QUALIFIED PERSONNEL

THIS DEVICE IS INTENDED FOR CONTINUOUS OPERATION!

TO REDUCE THE RISK OF FIRE OR ELECTRIC SHOCK, AND ANNOYING INTERFERENCE, USE THE RECOMMENDED ACCESSORIES ONLY.

WARNING:

- TO PREVENT FIRE OR SHOCK HAZARD. DO NOT USE THIS PLUG WITH AN EXTENSION CORD, RECEPTACLE OR OTHER OUTLET UNLESS THE BLADES CAN BE FULLY INSERTED TO PREVENT BLADE EXPOSURE.
- TO PREVENT FIRE OR SHOCK HAZARD. DO NOT EXPOSE THIS APPLIANCE TO RAIN OR MOISTURE.

CAUTION - LASER RADIATION WHEN OPEN, DO NOT STARE INTO BEAM.

VENTILATION WARNING - THE NORMAL VENTILATION OF THE PRODUCT SHALL NOT BE IMPEDED FOR INTENDED USE.



The lightning flash and arrow head within the triangle is a warning sign alerting you of "dangerous voltage" inside the product.



CAUTION: To reduce the risk of electric shock. Do not remove cover (or back). No user serviceable parts inside. Refer servicing to qualified service personnel.



The exclamation point within the triangle is a warning sign alerting you of important instructions accompanying the product.

Always follow basic safety precautions when using electrical products, especially when children are present.

WARNING: To avoid the risk of electrical shock, make sure the product is unplugged from the electrical outlet before relocating, servicing, or cleaning it.

Read all instructions before using

- Do not use this product near water.
- Do not ceiling- or wall-mount the product.
- Install the product in accordance with the operating instructions.
- Do not set the product near heat sources, such as radiators, heat registers, stoves, or other apparatus (including amplifiers) that produce heat.
- Protect the power cord from being walked on or pinched, particularly at plugs, convenience receptacles, and the point where they exit the product.
- Do not use attachments not recommended or sold by the product manufacturer as a risk of fire, electrical shock, or serious personal injury may result.
- Unplug the product during lightning storms or when unused for long periods of time.
- Do not expose the product to dripping or splashing water. Do not place objects filled with liquid (e.g., vases) on the product.
- Do not place in or expose the product to direct sunlight, extreme heat, humid or dusty locations.
- Never operate this product if it has a damaged power cord or plug, is not working properly, has been dropped, damaged, or exposed to moisture, water, or other liquids.
- Do not attempt to examine or repair this product yourself; take the product to a service centre for inspection and repair.
- Keep magnetic objects such as speakers, at a distance from the player.



LASER SAFETY

This set employs an optical laser beam system in the CD mechanism designed with built-in safeguards. Do not attempt to disassemble. Exposure to this invisible laser light beam may be harmful to the human eye. This is a Class-1 laser product. Use of controls, adjustments or procedures other than those specified herein may result in hazardous laser light beam exposure. This compact disc player should not be adjusted or repaired by anyone except qualified service personnel. The laser mechanism in the set corresponds to the stylus (needle) of a record player. Although this product uses a laser pick-up lens, it is completely safe when operated according to directions.

NOTE: The manufacturer is not responsible for any radio or TV interference caused by unauthorized modifications. Such modifications could void the user's authority to operate the equipment.

- 1) Operate turning controls and switches as instructed in the manual.
- 2) Before turning on the power for the first time, make sure that the power cord is properly installed.
- 3) Store your discs in a cool area to avoid damage from heat.

Battery Handling and Usage

NOTE: This style player contains rechargeable Lithium battery. There is a CR 2025 battery for remote control.

- 1) Never throw batteries into a fire. Do not expose batteries to fire or other heat sources.
- 2) Once the battery has reached the end of its life span, you need to carefully remove it from the player and dispose of it at your nearest recycling centre. To remove the battery carefully unscrew the base of the DVD player, then unscrew the main board, then simply detach the wires.

DISC handling and maintenance

Handling precautions

- Hold the disc by the edges so the surface will not be soiled with fingerprints. Fingerprints, dirt and scratches can cause skipping and distortion
- Do not write on the label side with a ball-point pen or other writing utensils.

- Do not use record cleaning sprays, benzine, thinner, static electricity prevention liquids.
- Be careful not to drop or bend the disc.
- Do not install more than 1 disc on the disc compartment.
- Do not try to close the disc cover when the disc is not installed properly.
- Be sure to store the disc in its exclusive case when not in use.

If the surface is soiled

Wipe gently with a soft, damp (water only) cloth.

When wiping discs, always move the cloth from the centre hole toward the outside, which will not cause distortion. (If you wipe the discs using a circular motion, circular scratches are likely to occur, which will cause distortion.)

If the disc is brought from a cold to a warm environment moisture may form on the disc

Wipe this moisture off with a soft, dry, lint-free cloth before using the disc.

Conservación incorrecta de los discos

Improper disc storage

You can damage discs if you store them in the following places:

- ⌋ Areas exposed to direct sunlight
- ⌋ Humid or dusty areas
- ⌋ Areas directly exposed to a heat outlet or heating appliance

Maintenance

- ⌋ Be sure to disconnect the AC adaptor before maintaining the player.
- ⌋ Wipe the player with a dry, soft cloth.
- ⌋ If the surfaces are extremely dirty ,wipe clean with a cloth which has been dipped in a weak soap-and-water solution and wrung out thoroughly, and then wipe again with a dry cloth.
- ⌋ Never use alcohol, benzine, thinner, cleaning fluid or other chemicals. And do not use compressed air to remove dust.

Accesorios



Remote control
.....1



Battery for Remote control
.....1



Instruction manual.....1



AC adaptor
.....1



Antenna1



Audio/Video cable1



Cigarette lighter
.....1

All the pictures in the instruction manual is just for your reference, specification should refer to actual accessories.

Table of contents

Safety information.....	1-2
Disc handing and maintenance.....	2-3
Accessories.....	3
Features	5
Control reference guide (Main Unit)	6
Control reference guide (Remote Control)	7
Basic connection	8-10
Remote control preparation.....	11
Play back a disk.....	12
JPEG CD.....	13-16
ATV.....	17-18
AV IN.....	18
DVD	19-21
DVB.....	22-27
USB&SD	27-28
System setting.....	29-30
Definition of terms.....	31
Specifications	32
Troubleshooting	33
Technical support	33

Features

9" TFT DISPLAY

This player has a built-in 9" TFT display window, to provide clear vision and low radiation.

SUPPORT DVD, DVB AND ATV PLAY

WITH GAME AND CALENDAR FUNCTION

BUILT-IN LITHIUM BATTERY

USB / CARD READER FUNCTION

This player can play USB/SD/MMC card containing files in CD/JPEG/MP3 format.

22 SECONDS ELECTRONIC SHOCKPROOF FUNCTION

A WEEKLY TV PROGRAM NAVIGATION

MULTI TV SYSTEM SUPPORT

The player can support TV signal system of PAL B/G,PAL I,PAL D/Kand SECAM L/L.

GRAPHICAL USER INTERFACE SCREEN

Simply by pressing the DISP button on the remote control, information on the player and disc can be displayed on the screen for easy identification. The player's operations and settings can be performed by operating the remote control while monitoring screen.

MULTI-AUDIO FUNCTION

The audio soundtrack can be heard in up to 8 languages. (The number of audio sound languages depends on the software.)

MULTI-SUBTITLES FUNCTION

Subtitles may be displayed in one of a maximum of 32 languages depending on the software.

MULTI-ANGLE FUNCTION

This function allows you to choose the viewing angle of scenes which were shot from a number of different angles. (Limited to DVD recorded with multiple camera angles.)

ROTATABLE SCREEN

The screen can be rotated from 0° to 180°clockwise,provide multi-angle of view (fig 1); Then the screen can be folded to lap over the main unit (fig 2)



PARENTAL LOCK FUNCTION

This prevents play unsuitable for children.

DISC FORMATS SUPPORTED BY PLAYER

The player can play back discs bearing any of the following marks:



MPEG4

Control reference guide

Main unit



1. **TFT display window** - Displays all information about DVD work scene.
2. **Remote control sensor**
3. **OPEN button** - To open the disc cover.
4. **SWITCH button** - Press this button to switch the ATV/AV IN/DVB/DVD/USB/SD MODE.
5. **STOP button** - Press this button to stop playing.
6. **LCD ON/OFF button** - Press this button to turn on or turn off the displaying of the screen.
7. **MENU button** - Press this button to return to the root menu(DVD) or to turn on/off the PBC (VCD).
8. **SETUP button** - Press this button to enter initial settings menu.
9. **CH+/PREV** - Press this button to move up and up the channel and play the previous chapter (for DVD) or track (for VCD/CD).
10. **CH-/NEXT** - Press this button to move down and down the channel and play the next chapter (for DVD) or track (for VCD/CD).
11. **OK button** - Press this button to confirm a selection.
12. **FF button** - Press this button to move right and play the disc forward at speeds: x2,x4,x8,x16,x32.

RIGHT SIDE VIEW



BACK SIDE VIEW

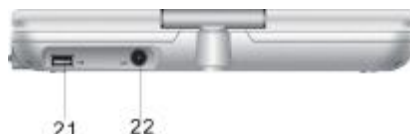

FRONT SIDE VIEW



13. **FR button** - Press this button to move left and play the disc backward at speeds: x2,x4,x8,x16,x32
14. **PLAY/PAUSE button** - Press this button to play or pause the playing discs.
15. **Phone** - Connect headphone to this jack for private listening.
16. **Volume** - Rotate this knob to adjust the volume to a suitable level.
17. **AV IN/Out jack** - Connect to TV or other external AV equipment to use the player as a signal source, or input the AV signal to the unit.
18. **Power switch** - Switch this knob to turn on/off the player.
19. **SD/MMC slot** - Insert SD/MMC card to play the files contained in those cards.
20. **DC In jack** - Power input jack.
21. **USB slot** - Insert USB to play the files contained in it.
22. **Antenna jack**
23. **Power indicator, charge indicator.**
24. **Built-in speaker**

Control reference guide

Remote control

- 1. SWITCH button** - Press this button to switch the ATV/AV IN/DVB/DVD/USB/SD MODE.
- 2. NUMERIC buttons** - Press these buttons to input numeric information, such as track number, chapter number and so on.
- 3. GO TO button** - Press this button to set the player to play disc starting at a certain point.
- 4. REPEAT button** - Press this button to repeat playing one chapter or one title (for DVD) or repeat playing the current track or the whole tracks (for VCD/CD).
- 5. SETUP button** - Press this button to enter initial settings menu.
- 6. SLOW button** - Press this button to play the disc at speeds: 1/2, 1/4, 1/8, 1/16, 1/32.
- 7. FR button** - Press this button to play the disc backward at speeds: x2, x4, x8, x16, x32.
- 8. TITLE button** - Press this button to return to title menu (for DVD).
- 9. MENU button** - Press this button to return to the root menu (for DVD) or to turn on/off the PBC (for VCD).
- 10. TELETEXT button** - Press this button to display the teletext.
- 11. GUIDE button** - To display all the channel program.
- 12. TV/MUSIC button** - Press this button to switch the TV or MUSIC.
- 13. FAV button** - To display your favorable channel program.
- 14. EPG button** - To guide a weekly channel programs.
- 15. INFO button** - To display the information of the channel program.
- 16. MUTE button** - Press this button to mute the sound.
- 17. AUDIO button** - To change audio output mode: Left Mono, Right Mono, Mix-mono and Stereo soundtrack (FOR VCD). Change language (FOR DVD).
- 18. SUBTITLE button** - Press this button to display and change subtitle language (For DVD only).
- 19. ANGLE button** - Press this button to display the angle number and change to different angles.
- 20. DISP button** - To display the time of Single Elapsed, Total Remain, Single Remain.
- 21. ZOOM button** - Press this button to enlarge picture size, max. to X 4 or to shrink picture size, min. to X1/4. In DVD mode, only zoom function.
- 22. TFT MODE button** - Press this button repeatedly to select  REVERSAL/INVERSION/RESET mode and then press left or right button to adjust or switch as you like.
- 23. PREV/CH + button** - Press this button to play the previous chapter (for DVD) or track (for VCD/CD), or go to next channel.
- 24. FF button** - Press this button to play the disc forward at speeds: x2, x4, x8, x16, x32.
- 25. ENTER button** - Press this button to confirm what you have selected.
- 26. EXIT** - To back to the previous menu (if there is not the exit icon in the menu), or exit the current interface.
- 27. NEXT/CH- button** - Press this button to play the next chapter (for DVD) or track (for VCD/CD), or go to previous channel.
- 28. STOP button** - Press this button to halt playing.
- 29. PLAY/PAUSE button** - Press this button to player pause the playing discs.
- 30. PRLIST button** - To enter the program list and scan the channel program.
- 31. MEMORY button** - To memory fast the current playing program if it is your favorite program. And will spring a window that "The favorite exist"
- 32. PG UP button** - To the up page.
- 33. PG DOWN button** - To the down page.
- 34. INVERSION button** - Press this button to inversion the picture which displayed.

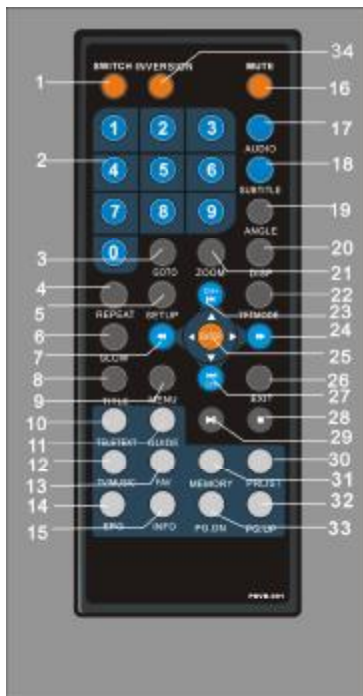

Basic connection

- Ensure all the cables are disconnected from the main unit before connecting to AC power source by AC power adaptor.
- Read through the instructions before connecting other equipment.
- Do not charge up the battery pack while the DVD player is working with the battery pack.

Connecting to AC power source



Rechargeable Battery Use

The player built-in a rechargeable Lithium battery.

1. Charge the battery

-Connect the adaptor to the DC 12V IN jack, then set the unit in POWER ON mode for fully charge (SLOW CHARGE).

-Or set in POWER OFF mode for fully charge (FAST CHARGE).

And the indicator is red during charging; it gets green when charging completed.

2. Time to recharge the battery

Recharge and playback time depends on battery pack capacity and the temperature condition.

Generally speaking, the battery needs to be charged about 3 hours in FAST CHARGE mode

And about 12 hours in SLOW CHARGE mode.

3. Using and Maintaining Rechargeable Battery

-The normal working condition temperature is: 0 ~45 ;

-Always unplug AC/DC power supply for the unit whenever not playing.

NOTE: A new battery pack which has not been used or one which has not been used for more than a month, may appear to not recharged enough, this is due to the characteristic of this battery and is not a malfunction. In this case, recharge it two or three times before the first use. It needs more than 6 hours to recharge battery while playing discs.

Noises may be generated during recharging. In this case, use a more distant power socket.

Do not recharge or discharge battery near a heating element such as a heater or direct sunlight.

Basic connection

Powering the system in a car

Plug one end of the cigarette lighter adapter into the DC input jack on the unit, then plug the other end into the cigarette lighter socket.

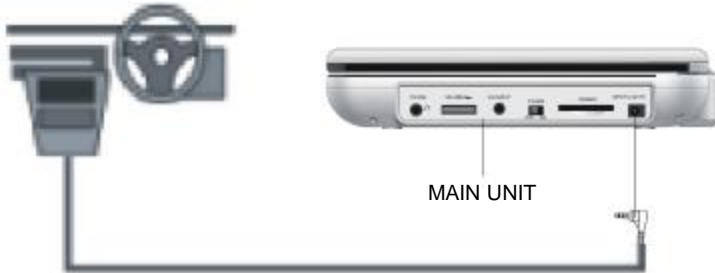

Connecting to a TV set

- It is recommended to connect a multi-system TV.
- Disconnect the AC adaptor before commencing connection.
- Do not block ventilation holes of equipment and arrange them so that air can circulate freely.
- Read through the instructions before connecting other equipment.
- Ensure that you observe the color coding when connecting audio and video cables.

Note:

During DVD play, the TV volume may be at a lower level than during TV broadcasts, etc. If this is the case, adjust the volume to the desired level.
If the DVD/VCD/CD player is connected to the TV through a video cassette recorder, the picture may not be played back normally with some DVDs. If this is the case, do not connect the player via the VCR.

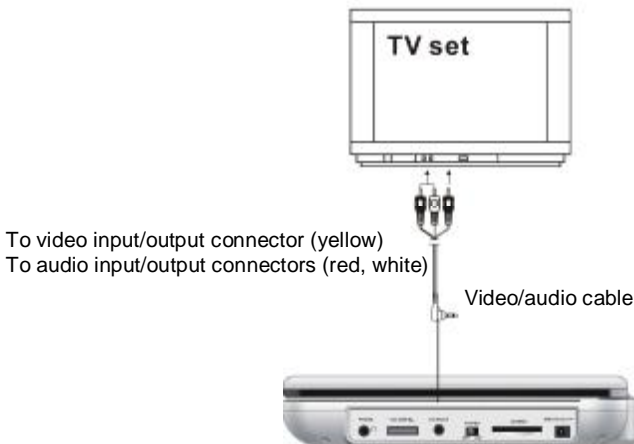

Basic connection

Connecting to audio equipment

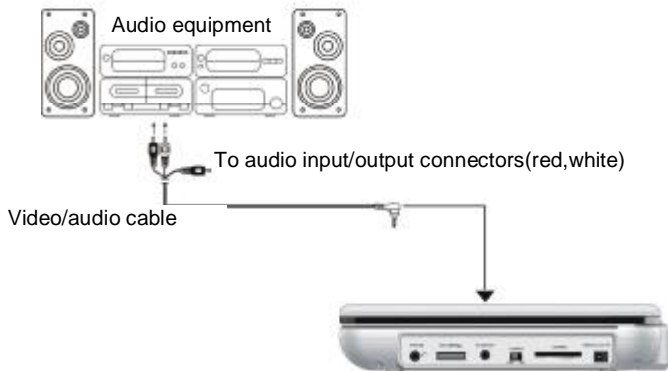

Connect headphone

1. Connect the headphone.

Adjust the volume to minimize the volume. Connect the headphone to phone jack.

2. Adjust the volume to the level that you want.

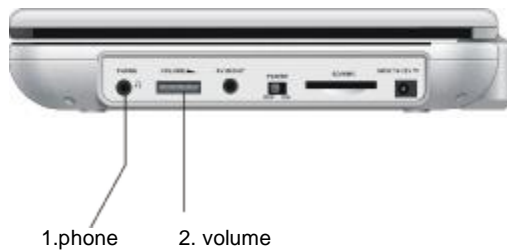

Remote control preparation

Battery installation

Insert the batteries while observing the correct (+) and (-) polarities as illustrated at right (Fig 1).

Service life of batteries

- I The batteries normally last for about one year although this depends on how often, and for what operations, the remote control is used.
- I If the remote control fails to work even when it is operated near the player, replace the batteries.
- I Use one size CR2025 battery.

Note:

- I Do not use rechargeable (Ni-Cd) batteries.
- I Do not attempt to recharge, short-circuit, disassemble, heat or throw the batteries into the fire.
- I Do not drop, step on or otherwise impact the remote control. This may damage the parts or lead to malfunction.
- I If the remote control is not going to be used for a long time, remove the battery.

Remote control operation

1. Remove the protective plastic tab before operating the remote control.
2. Point the remote control from no more than about 6 m from the remote control sensor and within about 60° of the front of the player (Fig 2).

NOTE:

- The operating distance may vary according to the brightness of the room.
- Do not point bright lights at remote control sensor.
- Do not place objects between the remote control and the remote control sensor.
- Do not use this remote control while simultaneously operating the remote control of any other equipment.

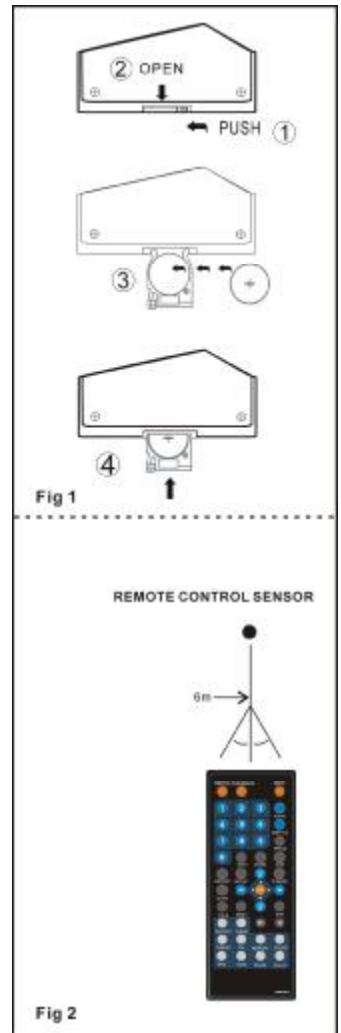

Before enjoying DVD/Video CD/CD

The On-Screen menu language of your player has been factory pre-set to English.

If you want to change the menu language to other language, please refer to "Initial settings / General setup / OSD language "In the explanation below it is assumed that English has been selected as menu language.

Playing Back a disc

HOW TO START PLAYBACK FROM THE MENU SCREEN

1. Press TITLE/MENU to access the menu screen..

2. Press ▲/▼/◀/▶ (cursor keys) or the numerical keys (will only work on certain discs) to select the desired title.

3. Press the ENTER or PLAY button.
The DVD video player will start playback from the selected title.

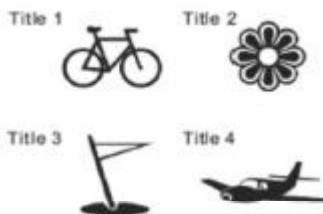

HOW TO PAUSE/ PLAYBACK

When paused, then press the PLAY button to resume normal playback

STOP PLAYBACK

Press the STOP button.
Playback will stop.

FAST FORWARD & REWIND

You can playback a disc at 2x, 4x, 8x, 16x or 32x the normal speed for fast forward or rewind.

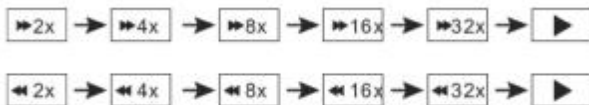

Press the FR or FF button during playback.
The playback speed changes, each time you press the FR or FF button(as shown above).

TO RESUME NORMAL PLAY BACK.
Press PLAY.

Note:

This function is not possible on some DVD discs or during certain sections of playback

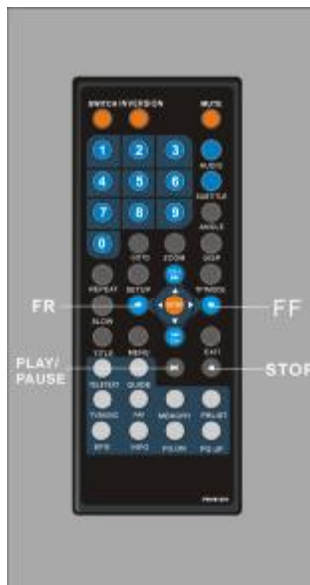

Playing Back JPEG/SONG

1. Load your JPEG disc.

2. Select a folder or a picture/track contained on the JPEG, a menu will appear on the screen.

NOTE: If the disc contains more than one folder. You need to press the "1" button then press UP button to enter the up folder, finally, enter root folder.

Press UP or DOWN to select a folder, and press ENTER to view folder contents.

3. Select playback mode.

You can use the button REPEAT to select one playback mode, repeat one (continually repeat the current picture/track) or all (repeat all pictures).

Press UP or DOWN or press numeric button to choose the picture or song you want to enjoy.

4. Start playback

Press ENTER/PLAY to playback the pictures or songs.

5. Use the STOP or MENU button to view the contents.

When JPEG CD is played, the MENU or STOP is used to display JPEG folders and the corresponding files.

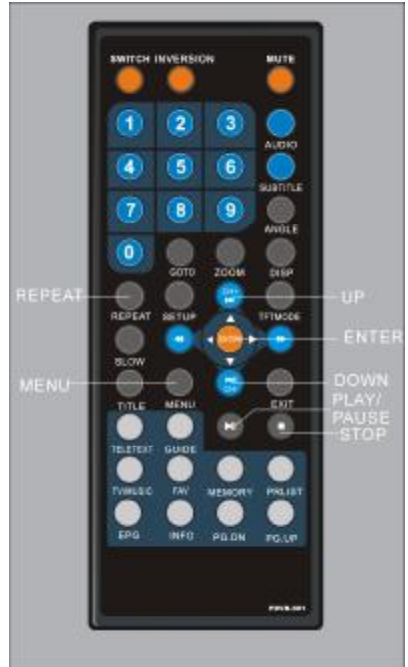

Playing MP3 Discs

MP3 is a format for storing digital audio. An audio CD-quality song is compressed into the MP3 format with very little loss of audio quality while taking up much less disc space. CD-R/RW discs that have been encoded in MP3 format are compatible with this system.

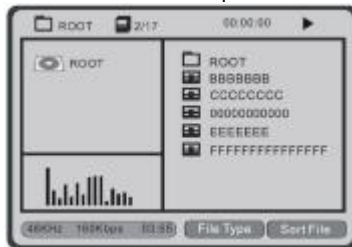

When a MP3 disc is inserted into the unit, the menu screen appears automatically. You can use the menu screen to select your desired folders and songs or the system plays the songs in the order they were burned into the disc.

1. Select a folder or a Mp3 song (The operation as it in playback JPEG)

2. Press ENTER or PLAY button to confirm.

3. Use UP/DOWN button to choose a song from the list.

NOTICE

"" icon in front of a file name indicates that this is a folder, not an MP3 file.

"MP3" icon in front of a file name indicates that this is a MP3 file.

Playing JPG files

- 1) Load the JPG Disc into tray.
 - 2) Select JPG file by pressing "UP /DOWN " or ENTER button .
- NOTE: If the disc contains more than one folder. You need to press the "1" button then press UP button to enter the up folder, finally, enter root folder.
- 3) You can preview the JPG file which you selected by pressing "PLAY" or "ENTER".
 - 4) Pressing the "LEFT " Key will rotate the picture 90 degrees counterclockwise. Pressing the "RIGHT" Key will rotate the picture clockwise.
 - 5) When previewing the file, pressing " TITLE ", "SUBTITLE", "AUDIO", "SLOW" , a hand icon will appear on the display meaning that these options are not available.
 - 6) Press "STOP" to browse the JPG file, "SLIDE SHOW" "ROTATE" will display on the screen.
 - 7) When browsing the picture, press "STOP" and thumbnail size picture will be displayed. You can select the picture you desire by using the UP/DOWN/LEFT/ RIGHT/ENTER key.

LOCATING A TITLE USING THE TITLE MENU

You can locate a specific title using the title menu function, if a DVD video disc contains a title menu.

1. Press the TITLE button, the title menu will be shown.
2. Press the cursor keys to select the title you want. You can also directly locate a specific title by pressing its assigned number with the numerical keys (this may only function on certain discs).
3. Press the ENTER button

This will cause the DVD video player to start playback from chapter 1 of the title selected.

You also can use or buttons to select a chapter or track desired: Press PREV or NEXT button repeatedly till the required Chapter/Title/Track is shown.

Playing Repeatedly

REPEAT A TITLE, CHAPTER OR DISC

THIS DVD VIDEO PLAYER ALLOWS YOU TO PLAYBACK A SPECIFIC TITLE, CHAPTER, TRACK REPEATEDLY. (TITLE REPEAT, CHAPTER/TRACK REPEAT)

During normal playback, press the REPEAT button. The repeat mode changes, each time you press the REPEAT button (as shown below).

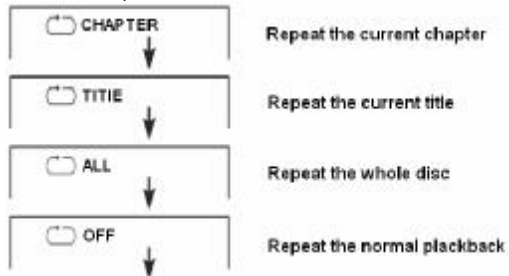

USING THE REPEAT FEATURE

The default mode for the Repeat feature is OFF. Pressing REPEAT consecutively changes the repeat options:

- o Track- repeats the track that is playing.
- o All- repeats the disc that is playing.
- o Off

As you toggle through the options, the repeat option changes. The selected repeat option loops repeatedly until you turn it off.

Locating a Specific Title,Chapter or Track

DVD DISCS ARE NORMALLY DIVIDED INTO TITLES WHICH ARE SUB-DIVIDED INTO CHAPTERS, CDS ARE DIVIDED INTO TRACKS.

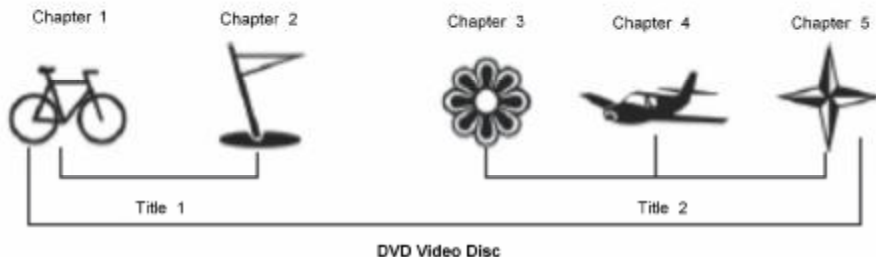

Subtitles

DISPLAY SUBTITLES

This player can display subtitles. To cycle through the available subtitle languages press the SUBTITLE button repeatedly.

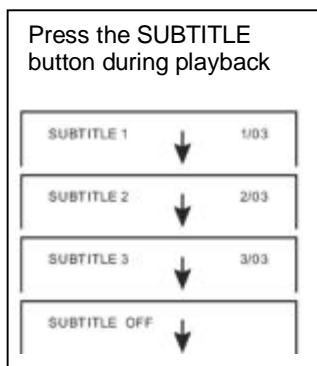

To TURN OFF the subtitle

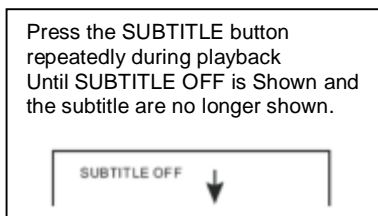

TFT MODE

Press TFT MODE button on the remote control, to enter below menus in consequence:



Press TFT MODE button repeatedly, to cycle display / / REVERSAL / INVERSION / RESET.

Press LEFT or RIGHT button to adjust in 0-100 when display / / , or to switch the screen display in reversal/ inversion mode.

JPEG CD

-For JPEG picture CD, select the folder you want to play .

NOTE: If the disc contains more than one folder. You need to press the "1" button then press UP button to enter the up folder, finally, enter root folder.

-The files in this folder are displayed and select your pictures by using the up/down navigation buttons and press ENTER button to start playback. Thumbnail of picture will be displayed while you scrolling across the file name.



-Once a folder and file is selected, the picture is loaded onto the screen.



NOTE: The time to load and display picture depends on the file size of the pictures.

-During playback, press **STOP** button to stop playback.

Skip to next/previous picture

Press NEXT button to skip to the next picture or PREV button to skip to the previous picture in MENU. Press ENTER/PLAY button to playback the picture.

When enter the picture, the picture will slide automatically.

Rotating pictures

-Press RIGHT navigation button to rotate the picture clockwise.

-Press LEFT navigation button to rotate the picture counter-clockwise.



Flipping pictures

-Press UP navigation button to flip the picture horizontally.

-Press DOWN navigation button to flip the picture vertically.

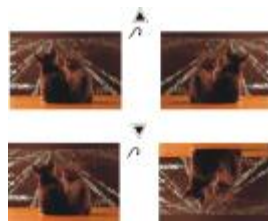

Picture Shrink/Zoom

-Press ZOOM button to enter the zoom mode.

-Press ZOOM button to shrink or zoom picture to 25%, 50%, 100%, 150% and 200%.



If the picture is enlarged, you may press navigation buttons to see other portions of the picture.



ATV

Before you tune the player for the first time, it is recommended you connect an outside static antenna (the type you use for your main TV). This will give the player the strongest signal possible to pick up any channels. Once the channels are stored you may then use the portable antenna provided you have a strong enough signal to pick up the channels

When the unit is operated at the first time, if you press the SWITCH function key.



ATV: Go to below main menu by pressing SWITCH button on the left top of the remote control. Move up/down button to select ATV. Make sure antenna or cable connected well.

Note: This machine has memory function. It'll auto save last mode.
i.e.: If last mode was set AV, it'll enter AV mode when start again.

AUTO-SEARCH

This machine can auto-search the channels. Once completed, it'll save the best tuning position to channel No. in order.

Press SETUP button repeatedly, to enter below menus in consequence:

SYSTEM menu



PRESET menu



You can setup above by moving Up/Down button, adjust or confirm by the right button.

Note: This machine supports SECAM system.

Move Up/Down button to highlight AUTO-SEARCH, and confirm by right button.

It'll start auto-search from the current channel. The machine will return to current channel upon search completed. To stop auto-search, press SETUP button.

POSITION

To set your favorite channel to a specific channel number

At Preset menu, highlight Position, confirm by the right button. The channel No. will change upon each pressing of the right button until your specified channel No. appeared.

Take channel No. 2. as an example.

Move Up/down button to highlight Search at Preset menu, and confirm by the right button, the machine will start searching channels. It'll stop upon each found channel. Keep searching until your favored channel appeared. Press SETUP button 3 times, to remove the subtitle, your favorite channel will be stored to the specified channel No. 2.

BAND

You can also speed up searching by BAND button.

FINE

To improve picture and sound quality.

SKIP

To skip some channels. At Preset menu, make SKIP ON.

AV IN



AV IN: Go to below main menu by pressing SWITCH button. Move up/down button to select AV IN.



Note: This machine has memory function. It'll auto save last mode.

i.e.: If last mode was set AV IN, it'll enter AV IN mode when start again.

Press TFT MODE button on the remote control, to enter below menus in consequence:



Press TFT MODE button repeatedly, to cycle display // REVERSAL / INVERSION / RESET.

Press LEFT or RIGHT button to adjust in 0-100 when display //, or to switch the screen display in reversal / inversion mode.

DVD

DVD Setting

When DVD Drive option is chosen, the unit will enter into DVD Mode. Putting a disc in it, the unit will identify automatically the format of disc and play it. Press SETUP button, the screen will display Main Menu. In this mode the DVB menu is unavailable to operate. Select DVD Setup by UP/DOWN, DVD Setup Page will be shown on the screen.



DVD Setup

The following shows the initial image of the DVD Setup page: Basic operation measures of the unit in DVD Setup mode will be introduced in the following content.



Menu

Select Audio by UP/DOWN, then enter into the submenu to set up the default audio language of DVD. When DVD disc does not support it, the first language on the disc will be chosen automatically to display.



Audio

Select Menu by using UP/DOWN button, then enter into the submenu to preset the default Menu Language. When DVD disc does not support it, the first language on the disc will be automatically chosen to display.

Subtitle

Select Subtitle by UP/DOWN button, then enter into the submenu to set default subtitle language. When DVD disc does not support it, the first language on the disc will be chosen automatically to display.

External Subtitle

Select External Subtitle by UP/DOWN button, then enter into the external submenu to set default external subtitle language. When DVD disc does not support it, the first language on the disc will be chosen automatically to display.

Custom Setup

Turn back from Language Setting by LEFT button, user can enter into Custom Setup by UP/DOWN .

Parental Ctrl

Press to select Parental Ctrl. To select the parental level by UP/DOWN . These are listed from the lowest level (1 kid) to the highest level (8 Adult). To cancel this function, select off option.



When the level needs to be changed, user has to enter the correct password.



Remark: To remind you again, the default pin for the unit is 8888.

SCREEN SAVER

This unit with the screen saver function. After 5 minutes it will display a DVD logo on the screen if there is not operation. You can setup it ON or OFF.

Angle Mark

Select Angel Mark by UP/DOWN button, if it is set as on, when playing DVD disc containing multi-angles, the screen will display current angles mark code and total number of angles.



Exit

Press Exit button to return to the Main Menu.

Note:

The unit does not support discs with formats of Codec MPEG4-4.12 and Codec MPEG4-5.05b (DRM DISC)

DVB

Before you tune the player for the first time, it is recommended you connect an outside static antenna (the type you use for your main TV). This will give the player the strongest signal possible to pick up any channels. Once the channels are stored you may then use the portable antenna provided you have a strong enough signal to pick up the channels

At the first time operation, the screen will display First Time Installation page. It will guide user to finish the initial setup of the DVB system.

Firstly, choose YES, then press ENTER button. The system will operate the initial setup.



Secondly, input regional information of user, including the country, OSD language and Time zone. DVB will automatically scan channels through the information.



Thirdly, choose "YES", the system will automatically scan the channels.

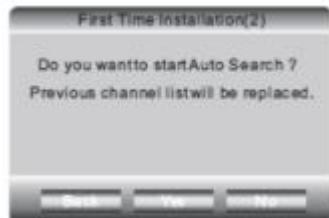

Fourthly, the system will directly enter DVB mode and play the first channel it finds.

In playing mode, press SETUP button, the unit will enter into the Main menu. At this moment DVD Setup is unavailable to operation. To enter into DVB Setup page, select DVB Menu.



DVB Menu

Program list



TV Program

This option allows user to edit the program list and set programs into three types, including Favorite program, Move the program and Delete. All programs available to watch are on the list. The three items (Favor, Move& Del) are used to set programs.



Favor

You can edit more than one programs as favorite programs by this option. Once a program is chosen, a mark will appear in its favor blank. To remove the cursor from the favor list, press ENTER bottom in the favor blank of that program.

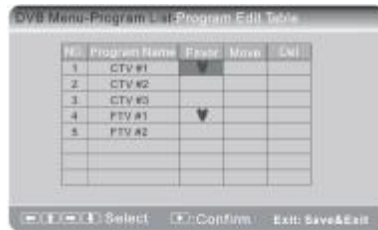

Move

This option allows user to change the order of programs on the list. When user choose the Move item of one program, a cursor will appear on the screen, then use the cursor to modify the order of programs. Then press ENTER button to confirm the setting.



Del

User can use this option to delete programs. To delete one program, Press ENTER button on the Delete blank of that program (a sign will appear there). Once the setting is reserved, the deleted programs will not appear on the list next time.



Notes: User can use Program Search option to recover the deleted programs.

Music Program

The operation setting of Music program is the same as that of TV Program.

SORT

You can sort channels on the list according to channel name, service ID or channel number.

Program search



Automatic Search

By operation of this option, the unit can automatically search channels according to the information in Country and Time Zone setting. Before searching, the system will indicate whether reserved channels in the program list are disposed to be deleted.

Choose Yes, new channels will replace the previous channels on the list.

Choose cancel to add these new channels to the list.



When the automatic search is over, DVB mode will return to play the last channel it searched. If pressing EXIT to suspend the search, new channels will be added to the list, but the unit will not return directly to the playing status at this moment.



Manual Search

To find particular channels, select this option searching manually. User must provide the numbers of target channels to enable the system to search.

The channels from manual search will be added to the list, but the unit will not return directly to the playing status at this moment.



Parental control

Channel Lock

Select Channel Lock to setup whether locks the blocked channels in Parental Setting. When it is set as Yes, user has to enter password before watching these locked channels.

When the option is changed to No from Yes, No need entering the password. But when it is changed from Yes to No, user must enter the password.

Parental Setting

Parental Setting can work together with Channel lock to lock channels.

Before entering into Parental Setting page, the system will require you to enter the password.



Enter correct PIN, user will enter into Parental Setting page.

When switch to the locked channel, user must enter correct PIN before watching.

Notes: the default PIN is 8888. To change it, return to Main Menu and select System Setting, then enter into System Setting Menu-Preference page, select Change PIN option.



System Setting



Country

Select this option to set the country where user receives the DVB signal.

Language

Enter into this submenu, there will be 3 options for user to operate: 1st Audio, 2nd Audio and Subtitle.

1st/2nd Audio

User can choose the audio language from audio 1st or audio 2nd. This option only works when the channel provides Audio. Otherwise, the preset language of that channel will be automatically chosen.

Subtitle

Select this option to choose subtitle language. This option only works when the channel provides subtitle. Otherwise, the preset subtitle language of that channel will be automatically chosen.

GMT Usage

Select this option to set the usage of GMT Time. When it is set with Off, Time Zone option will not work, users can set the time by themselves. When it is set with on, user can select Time Zone option to choose the time zone where the DVB system locates.

Time Zone

Select this option to set the time zone where the DVB system locates.

System Schedule

Select this option to preset the time for changing channel. User can preset 10 channels to watch at most.

Exit

To return to the Main Menu from DVB Setup page, press Exit button.

Basic Operation

Adjust Channel

-Press CH-/CH+ to turn to previous /next channels or press the number buttons on the remote control.

-In playing mode, press ENTER button again, the program list will be shown on the screen. Then choose channels by button, press PLAY button to play.

-During the playing, Press GUIDE button, the GUIDE MENU will be displayed. Under this mode, the icons of all channels will be displayed with smaller size. User can choose channel by UP/DOWN or LEFT/RIGHT button, then press play button to play.

Switching to the mute

Press Mute button to switch to mute mode, then the mute sign will appear on the screen. Press it again, the unit will return to normal playing.

Program Information

In DVB playing status, Press INFO button, the detail information of the program will be displayed on the screen.

Audio

Press audio button to choose audio output port (Audio 1 or Audio 2). There are three audio modes: LL, RR and LR.

Choosing Subtitle

Press subtitle button to choose subtitle language. The number of languages user can choose depends on subtitle languages programs provide. If no other language to choose, only off option appears there.

EPG page

Press EPG button to enter into EPG mode. Then user can use UP/DOWN button to choose channel and check the program list in the next two sections.

To return to playing mode, Press PLAY button.

To check the Complete program list of a day, press RIGHT button (The screen will display it).

Press UP/DOWN button to learn the detail information of one channel, those information will be shown on the right blank of program list. When one program is chosen, user can press Play button to setup the preset time for changing channel.

USB&SD

DVD Setting

When USB&SD Drive option is chosen, the unit will enter into DVD Mode.

Putting a disc in it, the unit will identify automatically the format of disc and play it. Press SETUP button, the screen will display Main Menu. In this mode the DVB menu is unavailable to operate.

Select DVD Setup by UP/ DOWN, DVD Setup Page will be shown on the screen.



DVD Setting

The followings show the initial image of the DVD Setup page: Basic operation measures of the unit in DVD Setup mode will be introduced in the following content.



Menu

Select Menu by using UP /DOWN button, then enter into the submenu to preset the default Menu Language. When DVD disc does not support it, the first language on the disc will be automatically chosen to display.



Audio

Select Audio by UP /DOWN , then enter into the submenu to set up the default audio language of DVD. When DVD disc does not support it, the first language on the disc will be chosen automatically to display.

Subtitle

Select Subtitle by UP/DOWN button, then enter into the submenu to set default subtitle language.

When

DVD disc does not support it, the first language on the disc will be chosen automatically to display.

External Subtitle

Select External Subtitle by UP/DOWN button, then enter into the external submenu to set default external subtitle language. When DVD disc does not support it, the first language on the disc will be chosen automatically to display.

Custom setup

Turn back from Language Setting, user can enter into Custom Setup by UP/DOWN button.

Control parental

Press to select Parental Ctrl. To select the parental level by UP/DOWN button. These are listed from the lowest level (1 kid) to the highest level (8 Adult). To cancel this function, select off option.



When the level needs to be changed, user has to enter the correct password.



Remark: To remind you again, the default pin for the unit is 8888.

Angle Mark

Select Angel Mark by UP/DOWN ,if it is set as on, when playing DVD disc containing multi-angles, the screen will display current angles mark code and total number of angles.



Exit

Press Exit button to return to the Main Menu.

System Setting



Select this option to setup some setting not related to DVD and DVB, the System Setting Menu will appear on the screen.

OSD

To set up the language on screen display, select this option to enter into the submenu. Then select OSD language by UP or DOWN button.



Display setup



Display Type

This option is used to choose the display ratio. If the video of channel is transmitted with 16:9 ratio, it can be switched to 4:3PS or 4:3LB. But if the video is transmitted with 4:3 ratio, it doesn't work.



Preference



Change PIN

Select this option to change the PIN (it is made up of 4 numbers). You must enter the previous PIN, then enter your new PIN twice, press Enter to confirm.

Remark: To remind you again, the default pin for the unit is 8888.



Default

Select this option to return to original setting. For example, if user operates this option in DVB Mode, all the setting in DVB mode will return to original setting.



Exit

Press Exit button to turn back to the Main Menu.

The measure of insert the card

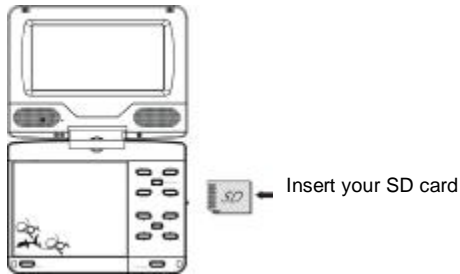

The measure of take out the card

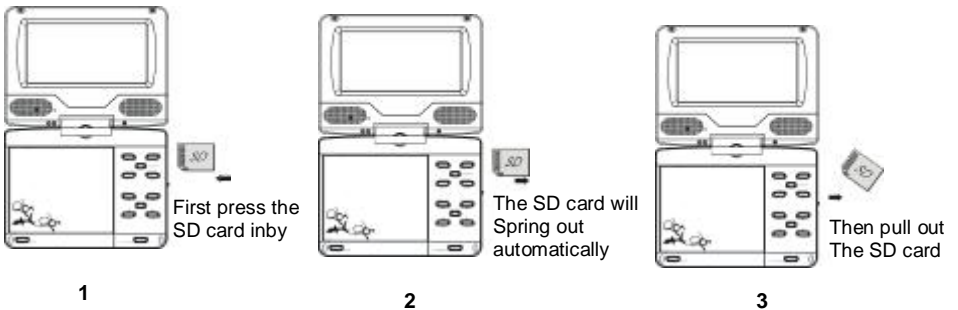

DEFINATION OF TERMS

DVD

This refers to a high-density optical disc on which high-quality pictures and sound have been obtained by means of digital signals. Incorporation a new video compression technology (MPEG II) and high-density recording technology, DVD enables aesthetically pleasing full-motion video to be recorded over long periods of time (for instance, a whole movie can be recorded). DVD has a structure consisting of two 0.6 mm thin discs which are adhered to each other. Since the thinner the disc, the higher the density at which the information can be recorded, a DVD disc has a greater capacity than a single 1.2 mm thick disc. Since the two thin discs are adhered to each other, there is the potential to achieve double-sided play sometime in the future for even longer duration play.

Video CD

This contains recordings of pictures and sound whose quality is on a par with that of video tape. This player also supports Video CDs with playback control (version 2.0).

MP3

These contain recordings of music which are compressed, allowing a significantly larger amount of music to be stored on a CD.

Angle

Recorded onto some DVD discs are scenes which have been simultaneously shot from a number of different angles (the same scene is shot from the front, from the left side, from the right side, etc.). With such discs, the ANGLE button can be used to view the scene from different angles.

Subtitles

This is the appearance of the dialogue at the bottom of the screen which are pre-recorded on some DVD discs.

Title number

These numbers are recorded on DVD discs. When a disc contains two or more movies, these movies are numbered as title 1, title 2, etc.

Chapter number

These numbers are recorded on DVD discs. A title is sub-divided into many sections, each of which is numbered, and specific parts of video presentations can be searched quickly using these numbers.

Time number

This indicates the play time which has elapsed from the start of a disc or a title. It can be used to find a specific scene quickly (It may not work with some discs).

Playback control (PBC)

This is recorded on a Video CD (version 2.0). The scenes or information to be viewed (or listened to) can be selected interactively with the TV monitor by looking at the menu shown on the TV monitor.

Track number

These numbers are assigned to the tracks which are recorded on Video CDs and CDs. They enable specific tracks to be located quickly.

Specifications

Power requirements : AC100-240V~ 50/60Hz ; DC12V=1500mA
Power consumption : ≤18W
Signal system : PAL B/G、 PAL D/K、 PAL I、 SECAM L/L
Resolution : 640 (RGB) X 234
Discs played :

1.DVB-T

CHANNEL BANDWIDTH : 7 MHz / 8 MHz
Frequency range : 7 MHz : 177.5 – 226.5 MHz
8 MHz : 474 – 858 MHz

2.ATV

Signal system: PAL B/G、 PAL D/K、 PAL I、 SECAM L/L

Frequency Range:

L(45.60-152.75MHz)
H(153.00-437.75MHz)
U(438.00-863.60MHz)

3.DVD

PLAY BACK A DVD/CD/JPEG/MP3/SONG

Signal system: PAL/NTSC

4.USB 1.1

5.CARD: SD /MMC

Video output level : 1 V_{pp}
Audio output level : 1.2 V
Earphone output level : (1KHz, 0dB, 25 mW)
Pickup : Wave length : 655 nm
Laser power : CLASS-1
Measurement : 264(L) X 202.5(W) X 40(D) mm
Weight : Approx. 1271g

Specification are subject to change without notice.

TROUBLESHOOTING

PROBLEM	SOLUTION
No sound or distorted sound	Make sure your DVB-T/TV is connected properly. Make sure all cables are securely inserted into the appropriate jacks.
Can't advance through a movie	You can't advance through the opening credits and warning information that appears at the beginning of movies because the disc is programmed to prohibit that action.
The icon (🔍) appears On screen	The feature or action cannot be completed at this time because: 1. The softwares of SD Card/USB restricts it. 2. The softwares of SD Card/USB don't support the feature (e.g., Angles) 3. The feature is not available at the moment. 4. You've requested a title or chapter number that is out of range.
Picture is distorted	The SD Card/USB might be damaged. Try another SD Card/USB It is normal for some distortion to appear during forward or reverse scan.
No forward or reverse scan	Some SD Cards/USB has sections that prohibit rapid scanning or title and chapter skip. If you try to skip through the warning information and credits at the beginning of a movie, you won't be able to. This part of the movie is often programmed to prohibit skipping through it.

TECHNICAL SUPPORT LINE

GENERAL SUPPORT CAN BE PROVIDED ON ALL
PRODUCTS PURCHASED FROM US

(Unfortunately we cannot provide support on products or components that we do not supply)

0161 975 0458

Calls cost National Rate, Unless dialing from 0161 area

CALLERS MUST BE MINIMUM OF 18 YEARS OF AGE

CALLERS MUST HAVE THE PERMISSION OF THE TELEPHONE SUBSCRIBER

ALL INFORMATION GIVEN IS CORRECT
AT THE DATE OF PUBLICATION - 01/11/2008

HOURS OF BUSINESS
MON – FRI 9am to 5pm (excludes bank holidays)

FASCIN8 LTD
14 EMBANKMENT BUSINESS PARK
VALE ROAD, HEATON MERSEY
STOCKPORT CHESHIRE, SK4 3GN

Alternatively visit our website for further support
www.fascin8.co.uk